

# Structural Performance Data

Premium Bi-Fold Door (8622)

**WEATHER SHIELD.**

**WINDOWS & DOORS**

| Unit Style   | Model Number | Size Tested<br>(total frame size) | NAFS<br>101/I.S.2/A440<br>Performance<br>Rating | Design<br>Pressure<br>Rating (psf) | Structural<br>Test Pressure<br>(psf) | Water<br>Performance<br>(psf) | Air Infiltration<br>(cfm/ft <sup>2</sup> ) | Forced Entry<br>Resistance | Data Valid<br>Until |
|--|--------------|-----------------------------------|---|------------------------------------|--------------------------------------|-------------------------------|--|----------------------------|---------------------|
| Bi-Fold Door - 4 Panel<br>Standard Sill <sup>1</sup> | 8622         | 159.53125"x99.6875"               | PG30-SP   | +/-30                              | +/-45                                | 4.50                          | 0.03                                       | 10 / A                     | 10/9/2027           |
| Bi-Fold Door - 4 Panel<br>Standard Sill <sup>1</sup> | 8622         | 160.53125"x121.75"                | LC-PG25-FLD                                     | +/-25                              | +/-30                                | 3.75                          | 0.13                                       | 10 / A                     | 10/18/2031          |

Revised 5/31/24

<sup>1</sup>Unit hinge Code 3L1R

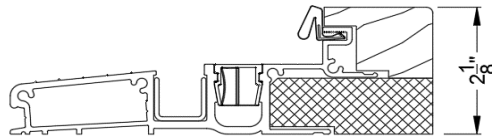

Standard Sill